



# *Blyde Canyon*

A FOREVER RESORT ★★ ★ / ★★ ★ ★ ★

*Inspired Conferencing...*  
*A truly majestic experience*



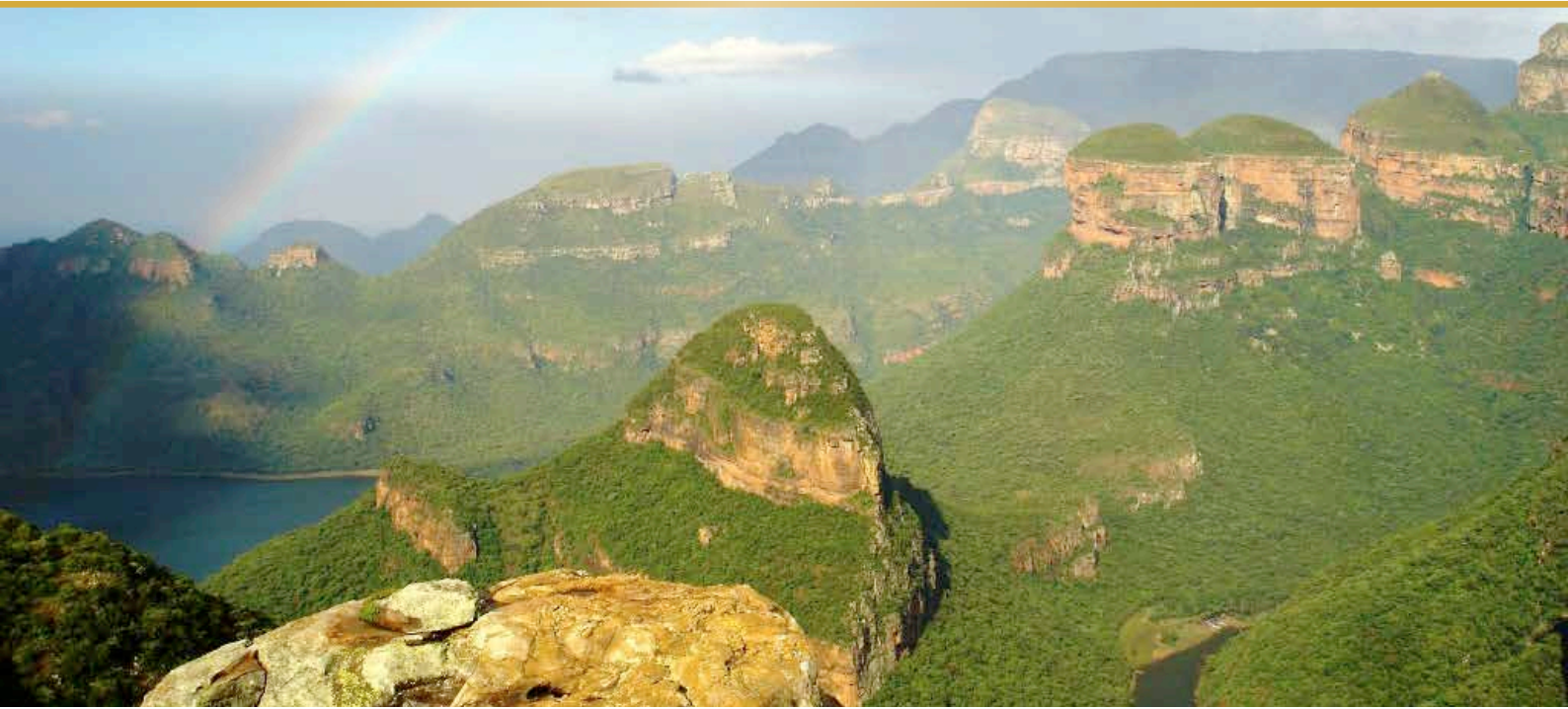

---

Blyde Canyon, a Forever Resort, offers you a beautiful setting for your next conference! With commanding views of the Blyde River Canyon, the third largest canyon in the world, why would you be anywhere else?

---

Situated in Mpumalanga en-route to the Panaroma Route and a mere 160 kilometers from Nelspruit, Blyde Canyon - a Forever Resort - offers a truly unique setting for any conference or event.

Our well-equipped conference facilities are ideal for groups between 25 to 400 delegates and all rooms are equipped with modern conference equipment. Conference programmes are tailor-made to allow delegates to enjoy the magnificent natural beauty of our

location and surrounding area. Conference programmes allow for sight seeing of the Mac Mac Waterfalls, Bourke's Luck Potholes' panoramic views from God's Window as well as a wide range of teambuilding and relaxation activities.

A guest house and rustic stone chalets, 30 caravan and camping stands, an excellent restaurant and its proximity to so many of Mpumalanga's attractions make this Resort perfectly located for your conference.

*Blyde Canyon, a Forever Resort, offers exciting conferencing programmes!*

# CONFERENCING & BANQUETING FACILITIES

ROOM	SEATING CAPACITY	CONFERENCE EQUIPMENT
<b>ALOE</b>		<b>STANDARD EQUIPMENT AVAILABLE:</b>
Cinema	400	Flipcharts
Class Room	250	Whiteboard
U-shape	80	Pens & markers
Banquet	200	Overhead projector
Dimensions: 22m x 15m	330sqm	Screen
<b>PROTEA</b>		Data Projector
Cinema	80	PA-System
Class Room	60	<b>Equipment Rentals:</b>
U-shape	36	VCR
Banquet	46	Monitor
Dimensions: 13m x 12m	156sqm	<b>Conference Services:</b>
<b>JASMYN</b>		Faxing
Cinema	30	Receiving faxes
Class Room	26	
U-shape	25	
Banquet	NA	
Dimensions: 10m x 7m	70sqm	
<b>AZALEA</b>		
Cinema	14	
Class Room	14	
U-shape	12	
Banquet	12	
Dimensions: 6m x 5m	30sqm	
<b>DISA</b>		
Cinema	14	
Class Room	10	
U-shape	NA	
Banquet	NA	
Dimensions: 3.24m x 3.48m	11.28sqm	

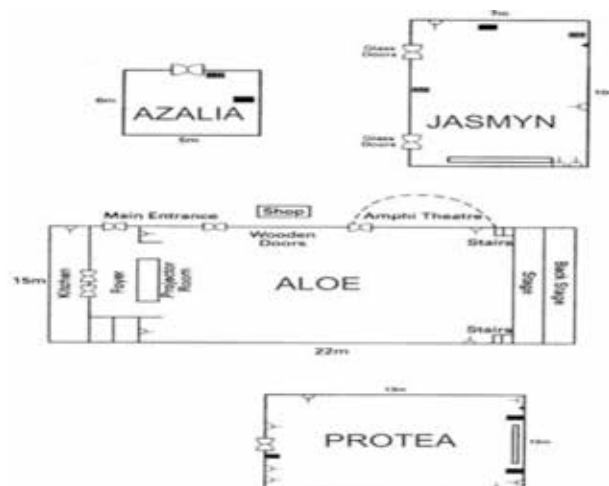

## EXHIBITION SPACE

Please contact the conference department for information

## FUNCTION VENUES:

### “Boma” – situated opposite restaurant

Available for “braai” functions for up to 80 Guests, catered by the Resort. (No roof - weather permitted)

### Main Hall – situated between the office and the shop

Available for functions, gala dinners & weddings.

Please contact the Resort for more information and costs involved.



Youth Hostel

Accommodation comprises of a guest house overlooking the gorge, 2 to 5-sleeper rustic stone chalets, 30 caravan & camping stands all with power points and serviced by two ablution facilities.

### 3-Star Graded (non smoking units)

#### SCD2 (10)

(Max 2 persons)

1 bedroom chalet: with a double bed, air-conditioning & television in the bedroom. Bathroom: with bath and shower, fully equipped kitchen: with a fridge & microwave. No lounge, carport, patio & "braai" facilities.

#### SCD4 (18) & HCD4 (4)

(Max 4 persons)

2-bedroom chalet: with a double bed in the main bedroom and 2 single beds in the spare bedroom. One bedroom with: television and air-conditioning. Bathroom, fully equipped kitchen with: fridge/microwave oven, carport, patio & "braai" facilities. (No lounge)

#### PCD6 (5)

(Max 6 persons)

2-bedroom chalet: with double bed and air-conditioning in the main bedroom. Remaining room has 2 single beds. Open plan lounge/dining area with 2 non-standard beds and television. Bathroom with: bath and shower. Fully equipped kitchen with: microwave and fridge, carport, patio & "braai" facilities. Club members only.

#### GHS6 GUEST HOUSE (1)

(Max 6 persons)

3 bedrooms with air-conditioning and en-suite bathrooms – 2 double beds in main bedroom. 2 single beds in each of the other 2 bedrooms. Separate guest toilet. Lounge with television & bar.

Dining room, fully equipped kitchen with microwave and fridge, lock-up garage for 3 vehicles, patio & "braai" facilities.

#### LCS2 (26)

(Max 2 persons)

1-bedroom chalet: with 2 single beds with air-conditioning. Bathroom: with bath, shower and toilet. Fully equipped kitchen: with breakfast nook, a 2-plate stove and microwave. Lounge with two tub chairs and television set, carport, patio and "braai" facilities.

### 4-Star Graded (non smoking units)

#### LCS4 (14) & PAR4 (2) – PARAPLEGIC UNITS

(Max 4 persons)

2-bedroom chalet with 2 single beds each. One bedroom: with air-conditioning. Bathroom: with bath, toilet and shower. Kitchen: fully equipped: stove (no oven), microwave, fridge, breakfast-nook, television set, carport, patio and "braai" facilities.

#### LCD4 (11)

(Max 4 persons)

2-bedrooms: chalet with double bed with air-conditioning in main bedroom and the 2nd bedroom with two single beds. Bathroom: Bath, shower & separate toilet. Kitchen: fully equipped stove (no oven) microwave, fridge. Open plan living facilities: air-conditioning, dining-room table & four chairs, coach & two tub chairs, television set, patio and "braai" facilities.

### CARAVAN PARK

30 well-shaded caravan stands, all with electricity, each with: "braai" facilities & rubbish bin. All stands are directly served by a tarred access road and water taps are within close proximity. Two ablution blocks: (one with a Laundromat). Kiddies play park.

### YOUTH HOSTEL

(Max 74 persons)

- 2 Dormitories (34 people/dormitory)
- Dormitory 1: 6 showers, 1 bath
- Dormitory 2: 4 baths & 1 shower
- 2 Teacher's rooms with a bath in each (1 - 2 people per room)
- Drivers Room: 1 bath
- All single beds.
- Kitchen: with fridge, stove, & Urn. Bring own cooking utensils, crockery, cutlery & glasses.
- Linen is provided but no towels.
- Extra's can be hired.
- "Braai" drums available
- No Televisions, no air conditioning



The facilities at Blyde Canyon, a Forever Resort, are of excellent standard. Guests can enjoy a sumptuous breakfast or refreshing sundowner on the restaurant's deck while admiring the magnificent view over the Three Rondavels.

### KADISHI RESTAURANT

Hours: 07h00 – 22h00

The Kadishi Restaurant and wine cellar offer a unique ethnic atmosphere where you can relax and enjoy the unforgettable view of the Three Rondavels. Enjoy our sumptuous buffets or have something from our snack menu, served in between meal times. Buffet for small and large groups.  
 Breakfast: 07h00 – 10h00  
 Lunch: 12h00 – 14h00  
 Dinner: 18h00 – 21h00  
 Coffee and snacks: 14h00 – 17h00

### LADIES BAR

A cocktail Bar is situated in the Kadishi Restaurant. Sundowners are also served on the restaurant patio.

### BLYDE SHOP

Hours: Mon-Thu: 08h00 – 18h00;  
 Fri: 08h00 – 20h00

The Blyde shop is a convenience store offering you a vast variety of consumer products including fresh produce and fresh meat. Wood and Charcoal is available from the Security at the Main Entrance after hours.

### LIQUOR STORE

Hours: Mon-Thu: 09h00 – 18h00;  
 Fri & Sat: 09h00 – 17h00

The Liquor Store is situated next to the Fuel Station at the Main gate. It offers a wide range of Estate Wines at reasonable prices. *Please note* that the store closes between 13h00 – 14h00.

### FILLING STATION - GARAGE

Hours: Mon-Thu: 06h00 – 18h00;  
 Fri & Sat: 06h00 – 18h00

The Petrol Filling Station is situated at the Main Gate.

### HOUSEKEEPING

Chalets are serviced once a day. For extended stays linen will be changed every 4th night. Clean towels are provided every day. Resort Laundromats are situated on Chalet levels 1, 2 & 3.

### WHEELCHAIR FACILITIES

2 Wheelchair friendly chalets are available 71 & 72, they offer the following:

- Wheelchair ramps into and out of chalet
- Easy access from parking areas
- Specially equipped bathrooms & toilets
- Indoor & outdoor areas of chalets are wheelchair accessible

Resort: Wheelchair ramps into and out of restaurant

### BANKS & AUTO TELLERS

An ATM is available on the resort and can be found in the Supermarket. First National Bank - available in Graskop.

### INTERNET FACILITIES / BUSINESS SERVICES

For faxing, photocopying and Internet facilities or any other business services required, please contact the reception. A tariff is applicable.

### RECEPTION

Hours: 07h00 – 20h00;

Our friendly staff at reception will gladly assist you with most of your enquiries. Should you have an emergency during the night, please contact security.

### CELL PHONE RECEPTION

Vodacom, Cell C & MTN coverage.

### TELEVISION RECEPTION

M-NET; KYK-net; E-TV; TV 1, 2, 3; Super sport 1 & 2; Movie Magic; Discovery Channel & Cartoon Network.



## *Location, location, location...*

Be sure to make a day trip out onto the Panorama Route and visit nearby attractions such as Bourke's Luck Potholes, Berlin Falls, Mac Mac Falls, God's Window and the Three Rondavels.

Blyde Canyon offers a superb setting to explore the surrounding attractions in the area. The resort also offers a variety of activities on-site, and is well-known for having some of the most spectacular hiking trails in Mpumalanga.

### Activities on-site:

- Swimming pool (Cold water)
- Tennis
- Badminton
- Mini golf
- Horse Rides
- Hiking Trails
- Trampolines
- Kids Play areas
- Volley Ball
- Picnic
- School Holiday Entertainment Program

### Nearby Attractions/facilities include:

- Blyde River Canyon
- Three Rondavels
- Bourke's Luck Pot Holes
- God's Window
- The Pinnacle
- Pilgrim's Rest (Historical Town)
- Berlin Falls, Lisbon Falls & Mac-Mac Falls
- Kruger Gate & Orpen Gate
- Echo Caves
- Golf course (in Hazyview & Pilgrim's Rest)
- The Shoe & Museum of Man (Ohrigstad)
- Helicopter- & balloon excursions

## CONTACT DETAILS

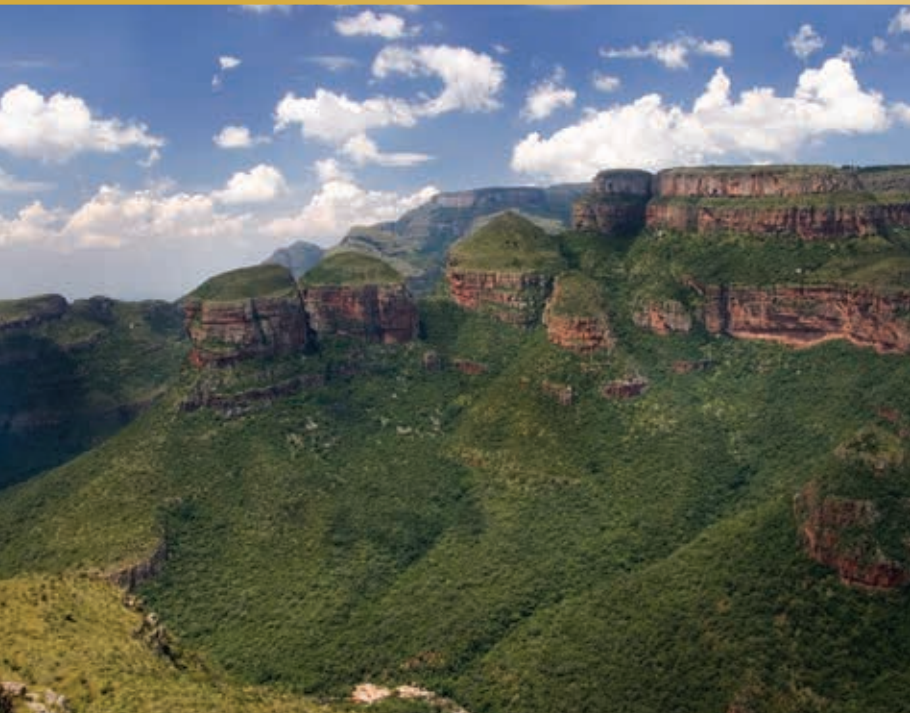

## *Contact us:*

### GENERAL ENQUIRIES:

Tel: 0861 22 69 66 / 0861 CANYON

Fax: +27 (0)13 769 8901

E-mail: [blyde@foreversa.co.za](mailto:blyde@foreversa.co.za)

Private Bag X405, Graskop, 1270

GPS Coordinates: 24° 34' 50" S / 30° 46' 20" E

### CONFERENCE ENQUIRIES:

Tel: +27 (0)86 122 6966

Fax: +27 (0)13 769 8901

E-mail: [blydeconf@foreversa.co.za](mailto:blydeconf@foreversa.co.za)

[conference@foreversa.co.za](mailto:conference@foreversa.co.za)

[www.foreversa.co.za](http://www.foreversa.co.za)

**Directions:** Between Ohrigstad & Graskop.

Take the R22 from JHB or the N4 from Pretoria, past Witbank and Middelburg to Belfast. Take the R540 through Belfast to Dullstroom. Proceed on the R36 to Lydenburg and continue to Ohrigstad. After 22km turn right onto the R532 (the Graskop Road) the Resort is 21 km further on the left.